

THE LANGHAM

SHANGHAI, XINTIANDI

FLOOR PLAN LEVEL 2

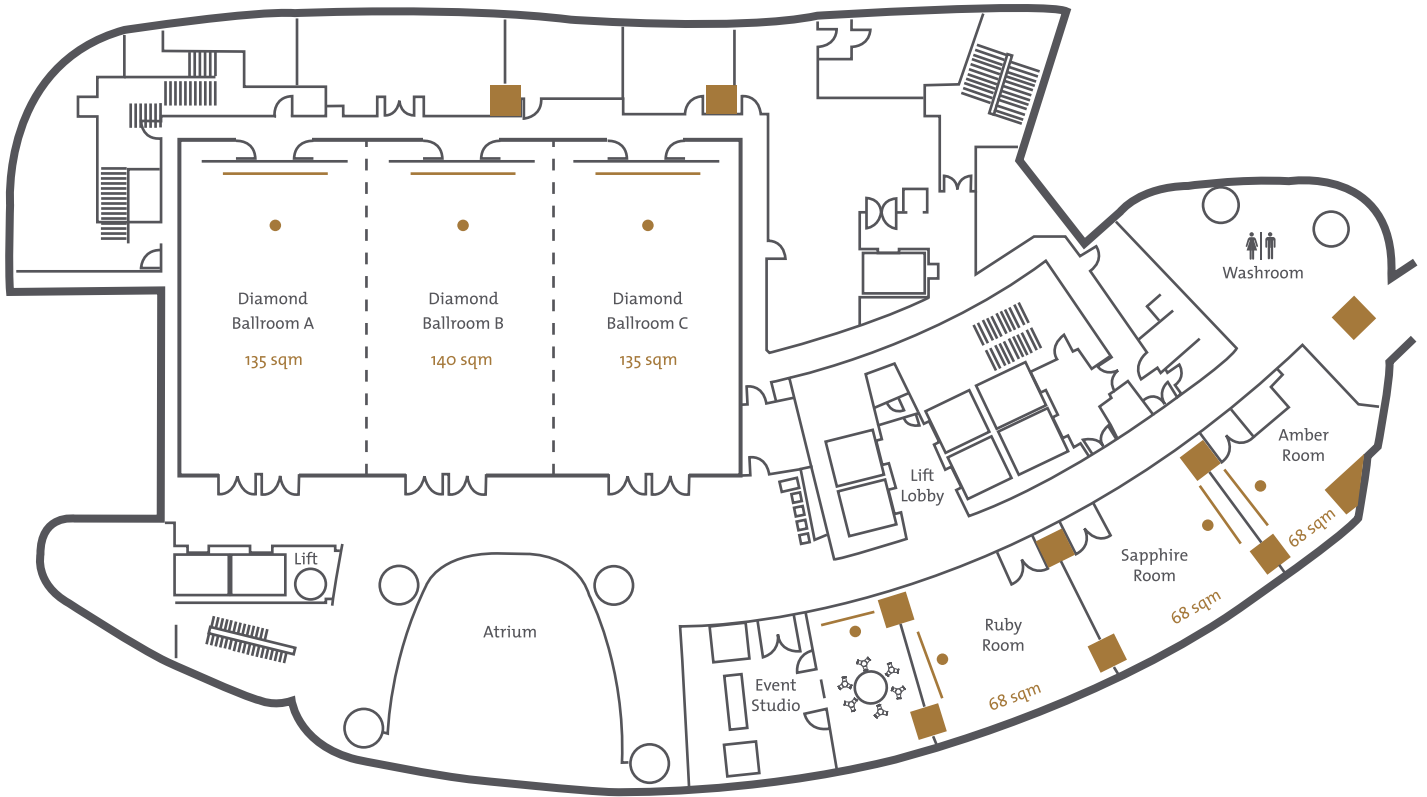

150-inch projector screen, 7,000 lumens in Diamond Ballroom

100-inch projector screen, 5,000 lumens in Ruby / Sapphire / Amber Rooms

● built-in projector — built-in projector screen

	Area		Dimension		Height		Capacities					
	Sqm	Sqft	Metres	Feet	Metres	Feet	Classroom	U-Shape	Theatre	Cocktail	Banquet	Cabaret
LEVEL 2 VENUES												
Diamond Ballroom	410	4,413	27.35x15	89.7x49.2	4.6	15.1	216	99	360	360	264	176
Diamond Ballroom A+B	275	2,960	18.35x15	60.2x49.2	4.6	15.1	126	66	192	220	168	120
Diamond Ballroom B+C	275	2,960	18.35x15	60.2x49.2	4.6	15.1	126	66	192	220	168	120
Diamond Ballroom A	135	1,453	9x15	29.5x49.2	4.6	15.1	63	33	96	110	84	56
Diamond Ballroom B	140	1,507	9.35x15	30.7x49.2	4.6	15.1	63	33	96	110	84	56
Diamond Ballroom C	135	1,453	9x15	29.5x49.2	4.6	15.1	63	33	96	110	84	56
Ruby Room	68	731	9.9x7.9	32.5x25.8	4	13.1	36	20	45	40	48	32
Sapphire Room	68	731	9.9x7.8	32.4x25.7	4	13.1	36	20	45	40	48	32
Amber Room	68	731	9.8x7.5	25.6x24.6	4	13.1	Boardroom seating for 16 persons					

THE LANGHAM

SHANGHAI, XINTIANDI

上海新天地朗廷酒店 2层平面图

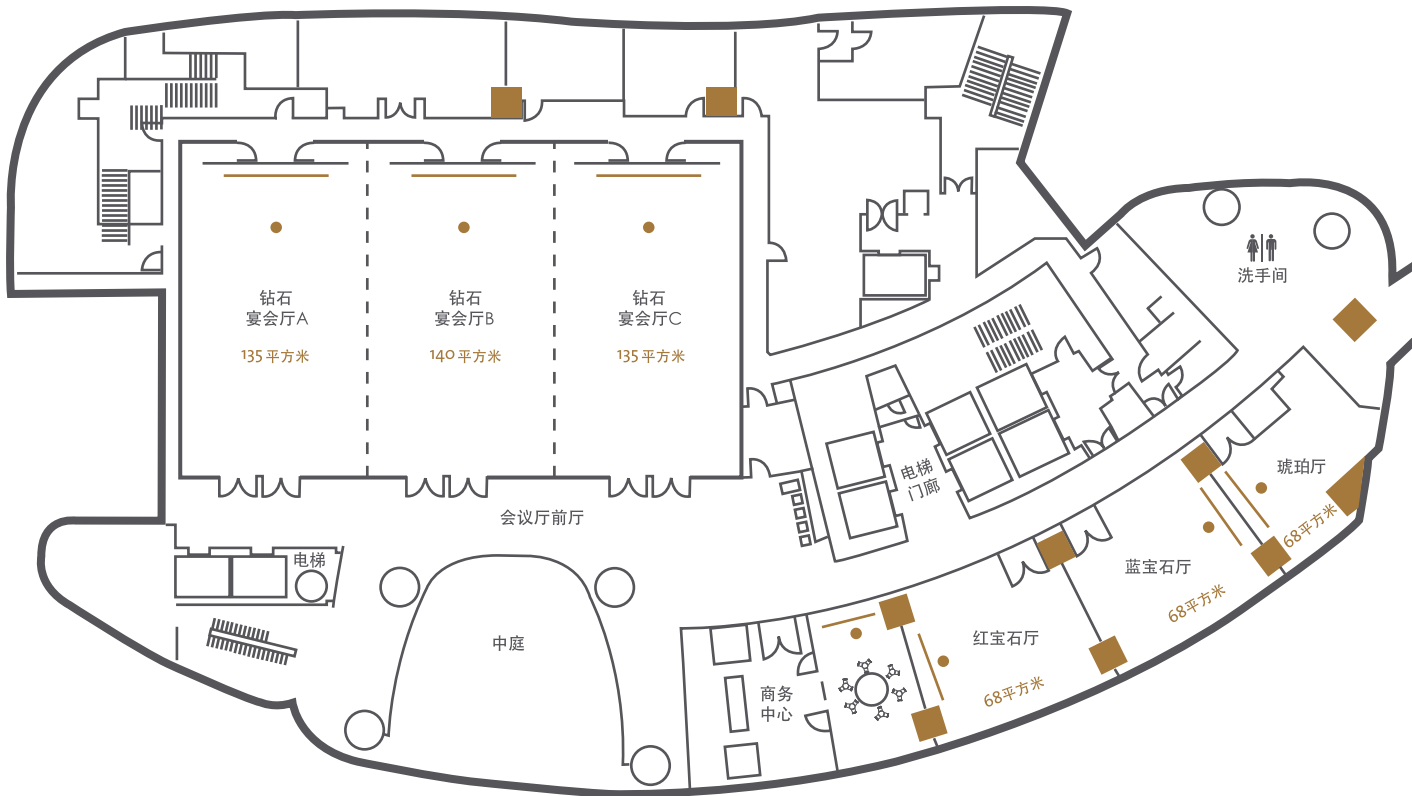

钻石宴会厅投影仪屏幕为150吋，液晶投影仪流明度为7000

红宝石 / 蓝宝石 / 琥珀厅及投影仪屏幕为100吋，液晶投影仪流明度为5000

● 内置式投影仪 — 内置式投影屏幕

	面积		规格		高度		人数					
	平方米	平方米英尺	米	英尺	米	英尺	课堂式	U-型	剧场式	酒会式	宴会式	半圆型
二层会议场地												
钻石宴会厅	410	4,413	27.35x15	89.7x49.2	4.6	15.1	216	99	360	360	264	176
钻石宴会厅 A+B	275	2,960	18.35x15	60.2x49.2	4.6	15.1	126	66	192	220	168	120
钻石宴会厅 B+C	275	2,960	18.35x15	60.2x49.2	4.6	15.1	126	66	192	220	168	120
钻石宴会厅 A	135	1,453	9x15	29.5x49.2	4.6	15.1	63	33	96	110	84	56
钻石宴会厅 B	140	1,507	9.35x15	30.7x49.2	4.6	15.1	63	33	96	110	84	56
钻石宴会厅 C	135	1,453	9x15	29.5x49.2	4.6	15.1	63	33	96	110	84	56
红宝石厅	68	731	9.9x7.9	32.5x25.8	4	13.1	36	20	45	40	48	32
蓝宝石厅	68	731	9.9x7.8	32.4x25.7	4	13.1	36	20	45	40	48	32
琥珀厅	68	731	9.8x7.5	25.6x24.6	4	13.1					16人董事会布置	